

NOTES: UNLESS OTHERWISE SPECIFIED

1. SEE DRAWING NO. CB-00279 AND PROCEDURE P-1000 FOR ASSEMBLY AND TEST INSTRUCTION. PROCEDURES AND ASSEMBLY DRAWINGS ARE FOR INTERNAL USE ONLY.
2. ALL TESTING ARE IAW BATTERY COUNCIL INTERNATIONAL STANDARDS.
3. ALL DIMENSIONS ARE IN INCHES [MM].

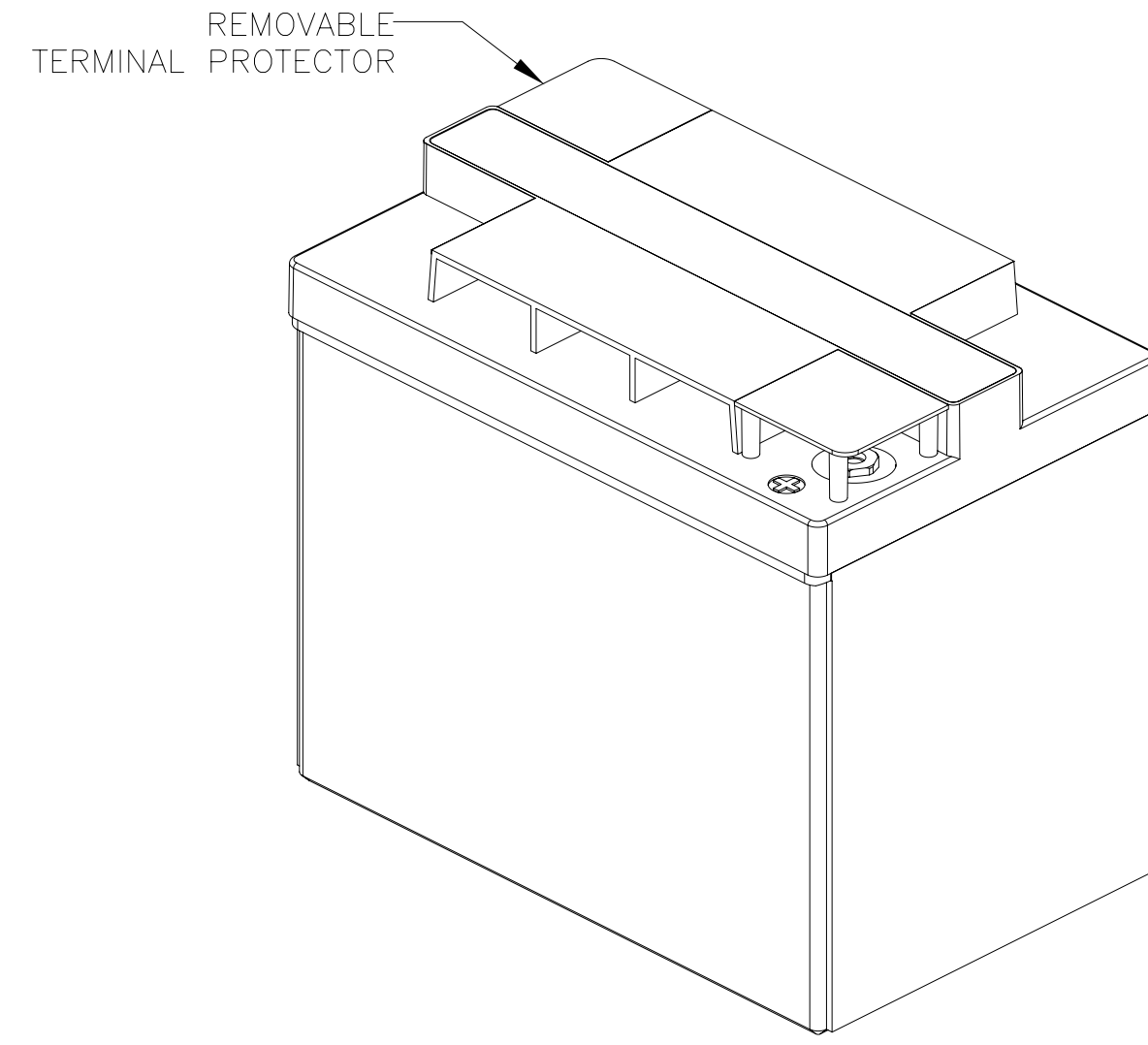

REFERENCE VIEW

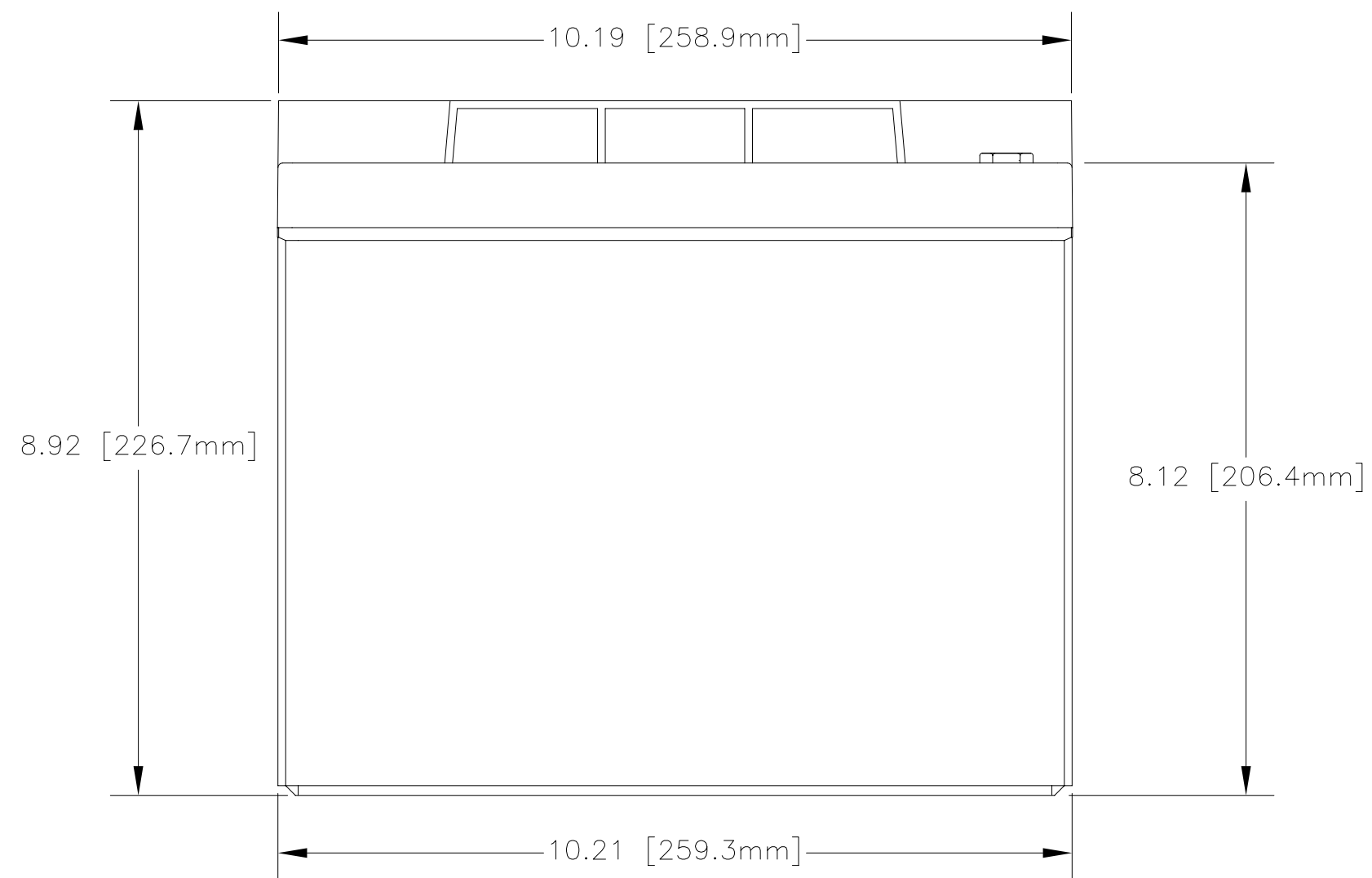
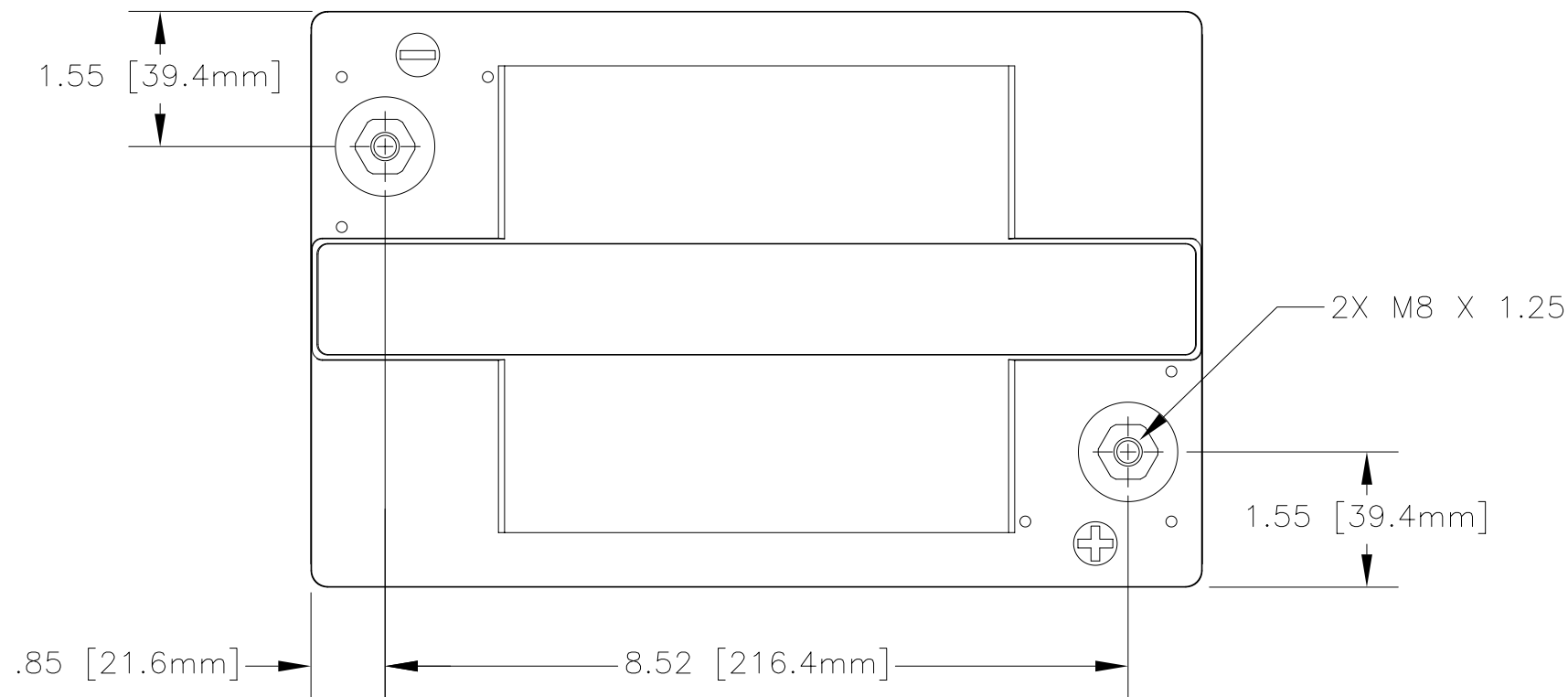
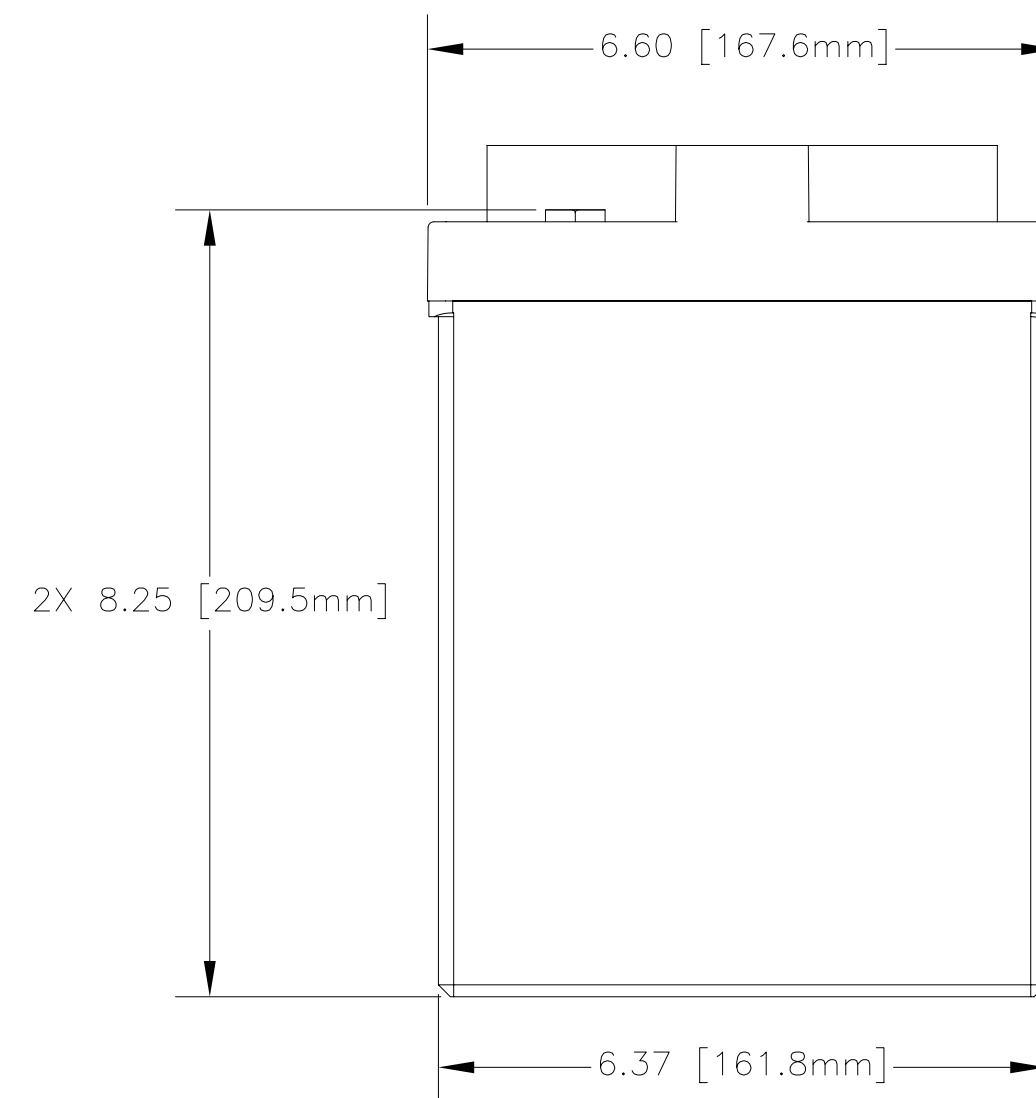

ENVELOPE DRAWING

CAPACITY RATINGS	
PART NUMBER	AGM-6100T
NOMINAL WEIGHT	42 LBS [19.1 KG]
AMPERE HOUR CAPACITY @ 20 HOUR 1.75 VOLTS/CELL @ 77°F (25°C)	100 AH
MINUTES OF DISCHARGE @ 25 AMPS 1.75 VOLTS/CELL @ 77°F (25°C)	193 MIN

QTY REQD	CAGE CODE	PART OR IDENTIFYING NO.	NOMENCLATURE OR DESCRIPTION	MATERIAL SPECIFICATION	ITEM NO.
PARTS LIST					
UNLESS OTHERWISE SPECIFIED DIMENSIONS ARE IN INCHES TOLERANCES ARE:			CONCORDE BATTERY CORPORATION 2009 SAN BERNARDINO RD, W. COVINA, CA 91790		
FRACTIONS	DECIMALS	ANGLES	APPROVALS	DATE	TITLE
± 1/32	.XX ± .06	± 1'	DRAWN A. MISTRETTA	9/27/05	BATTERY, 6 VOLT, AGM-6100T
	.XXX ± .030		CHECKED AMIII	9/28/05	SIZE CAGE CODE
TREATMENT	NONE	APPROVED JBT	9/28/05	DWG NO. AGM-6100T	REV
FINISH	NONE	ISSUED NS	9/29/05	SCALE NONE	SHEET 1 OF 1
SIMILAR TO NA	ACT WT NA	CALC WT NA			

REVISIONS			
REV	DESCRIPTION	DATE	APPROVED